

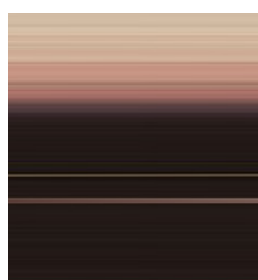

LAB TWENTYTWO
BARCELONA

TRIBUTE PORTFOLIO

MICE BROCHURE



LAB TWENTYTWO

TRIBUTE
PORTFOLIO

We take great pride in our Business meetings,
conference, and event spaces offerings where guests
and locals are welcome to indulge.

MICE BROCHURE



WELCOME

Introducing Labtwentytwo Barcelona, a ground-breaking destination situated in the vibrant 22@ district of Barcelona. Our name embodies our essence and resonates with the innovative spirit that surrounds us. As a prominent player in this up-and-coming area, we embrace the future with forward-thinking and sustainability at our core. The design of our hotel is a testament to our commitment to cutting-edge technology and eco-consciousness.

Inspired by the wind and sea, our organic and flowing architecture mirrors the graceful waves, while the smoothed edges evoke the sculpting touch of the breeze. Welcome to the first Tribute Portfolio hotel in Barcelona, where innovation meets design for a remarkable experience.

CONTENTS

Meetings



1



Facilities, features
& equipment



2



Food & beverage
offerings



3



Events



4



Sustainability



5



Contact &
directions



6



MEEETINGS

Whether you're hosting a business meeting, a corporate conference, a training session, or a special event, we understand the importance of having top-notch facilities to ensure the success of your gathering. Our hotel is delighted to offer a range of meeting room facilities that are designed to cater to your specific needs and elevate your event to the next level.



MEETING TYPES

Seminars

Training sessions

Management

Team Building

Conferences



Launches

Product presentations

Boardroom workshops

We would be happy to work with you to create a tailored package that suits your specific needs and requirements should you have a different meeting or event.



FACILITIES

Labtwentytwo Barcelona is committed to delivering the utmost in corporate event excellence. With our recently reconfigured convertible meeting rooms, we offer a superior level of adaptability, enabling you to customize your gatherings to perfection. Whether you opt for Lab1, Lab2, Lab3, Lab4, or Lab5, you'll discover an ideal environment for hosting successful corporate meetings, seminars, workshops, and a multitude of other events tailored precisely to your needs.

ROOM CONFIGURATION

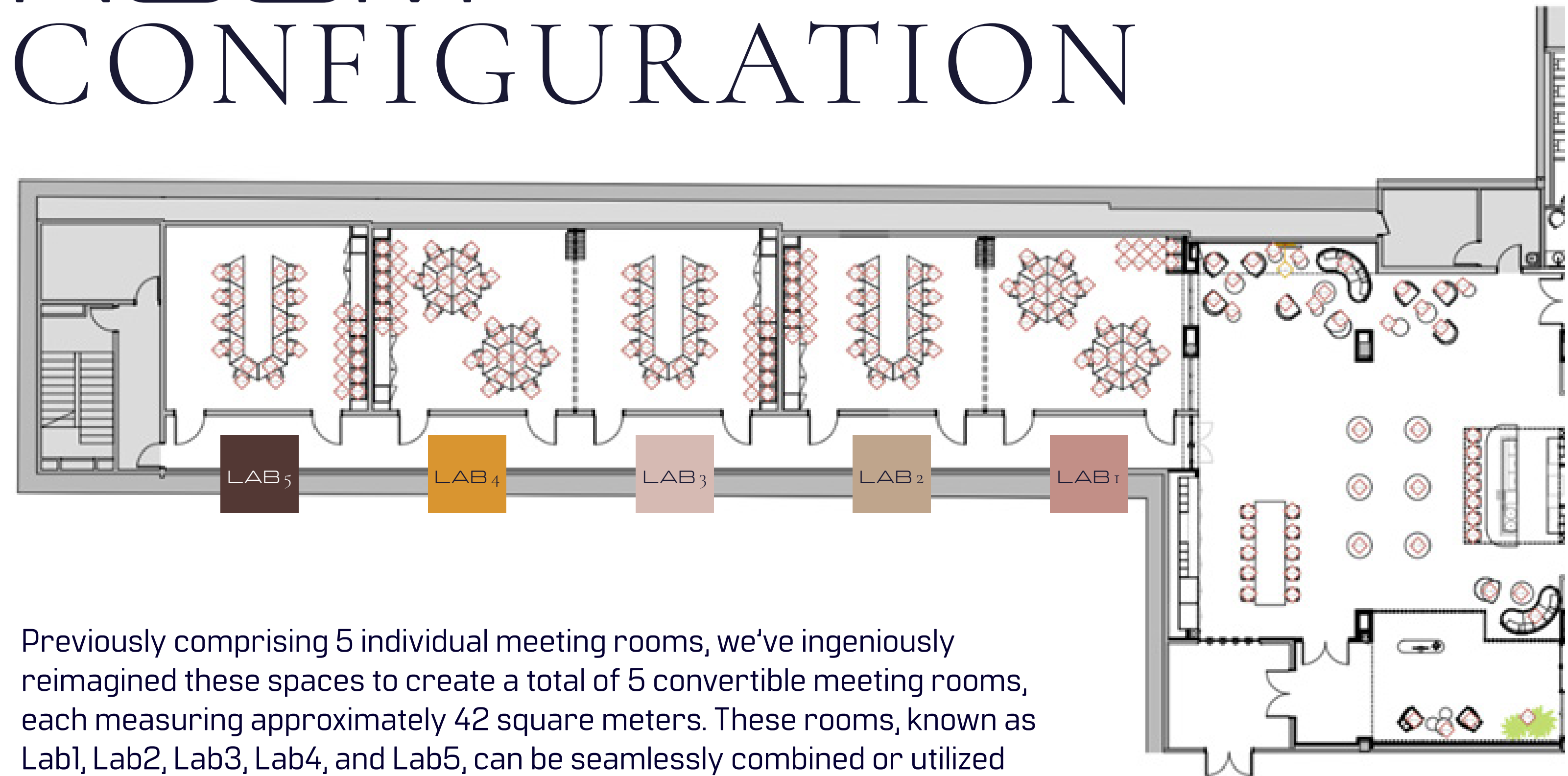

Previously comprising 5 individual meeting rooms, we've ingeniously reimaged these spaces to create a total of 5 convertible meeting rooms, each measuring approximately 42 square meters. These rooms, known as Lab1, Lab2, Lab3, Lab4, and Lab5, can be seamlessly combined or utilized individually, offering a dynamic environment for your events.

INDIVIDUAL

ROOMS | 42 SQM EACH

These individual rooms provide intimate settings for focused discussions, breakout sessions, or small group meetings. Each room can be tailored to your specific requirements, ensuring an ideal atmosphere for productive interactions.



	TOTAL SIZE	LENGTH X BREATH	HEIGHT
LAB 1	49,15 sqm	7,68 X 6,40 m	2,50 m
LAB 2	48,50 sqm	7,58 X 6,40 m	2,50 m
LAB 3	48,50 sqm	7,58 X 6,40 m	2,50 m
LAB 4	46,45 sqm	7,25 X 6,40 m	2,50 m
LAB 5	46,81 sqm	7,41 X 6,40 m	2,50 m

Theater - 35 People
Classroom - 20 People
U-shape - 12 People

Boardroom - 14 People
Cabaret - 12 People

COMBINED

ROOMS | 84 SQM EACH

When a larger space is needed, Lab2+Lab3 or Lab4+Lab5 can be effortlessly merged into a single room measuring 93 or 97 square meters. This expansive setting is ideal for hosting workshops, presentations, or collaborative sessions with a larger audience.



	TOTAL SIZE	LENGTH X BREATH	HEIGHT
<div><div>LAB 1</div><div>LAB 2</div></div>	93,26 sqm	14,57 x 6,40 m	2,50 m
<div><div>LAB 3</div><div>LAB 4</div></div>	97 sqm	15,16 x 6,40 m	2,50 m

Theater - 80 People
Classroom - 40 People
U-shape - 28 People

Boardroom - 30 People
Cabaret - 28 People



FEATURES & EQUIPMENT

Discover the features that make our meeting rooms
the preferred choice for your next successful event.



TECHNICAL FEATURES

Audiovisual Equipment

High-quality audio and visual equipment, including projectors, screens, and sound systems, to enhance presentations and communication.

Wi-Fi Connectivity

Reliable and high-speed Wi-Fi to keep you seamlessly connected throughout your meeting.

Flexible Seating Arrangements:

Configurable seating options to accommodate various meeting formats, from boardroom style to theater-style setups.

Professional Lighting:

Well-lit spaces with adjustable lighting to create the right ambiance and focus.

Climate Control:

Temperature-controlled environments to ensure comfort for all attendees.

Catering Services:

Access to catering services for coffee breaks, meals, and snacks to keep your team energized.

Whiteboards and Flipcharts:

Tools for visualizing ideas and facilitating discussions during your meetings.

Meeting Supplies: Pens, notepads, and other essential supplies to support productive discussions.

On-Site Support:

Dedicated staff to assist with technical issues, room setup, and any additional requirements.

Privacy Features:

Soundproofing and secure access to ensure confidentiality and a distraction-free environment.

Accessibility:

Rooms equipped to accommodate individuals with mobility challenges and other accessibility needs.

FOOD & BEVERAGE

Labtwentytwo offers three on-site food and beverage options as well as a breakfast service.



3

CONCEPT

We take great pride in our diverse food and beverage offerings where guests and locals are welcome to indulge. Whether you're looking for a stylish evening, a delightful rooftop experience with its tantalizing small plates, or a satisfying all-day dining adventure featuring international cuisine, we have gastronomic desires covered with our range of dining options.



Alcachofa Resto. International cuisine, seafood minded. The destination where we take care of our food. For you, for us and for our future.

[VIEW THE FULL BROCHURE](#)

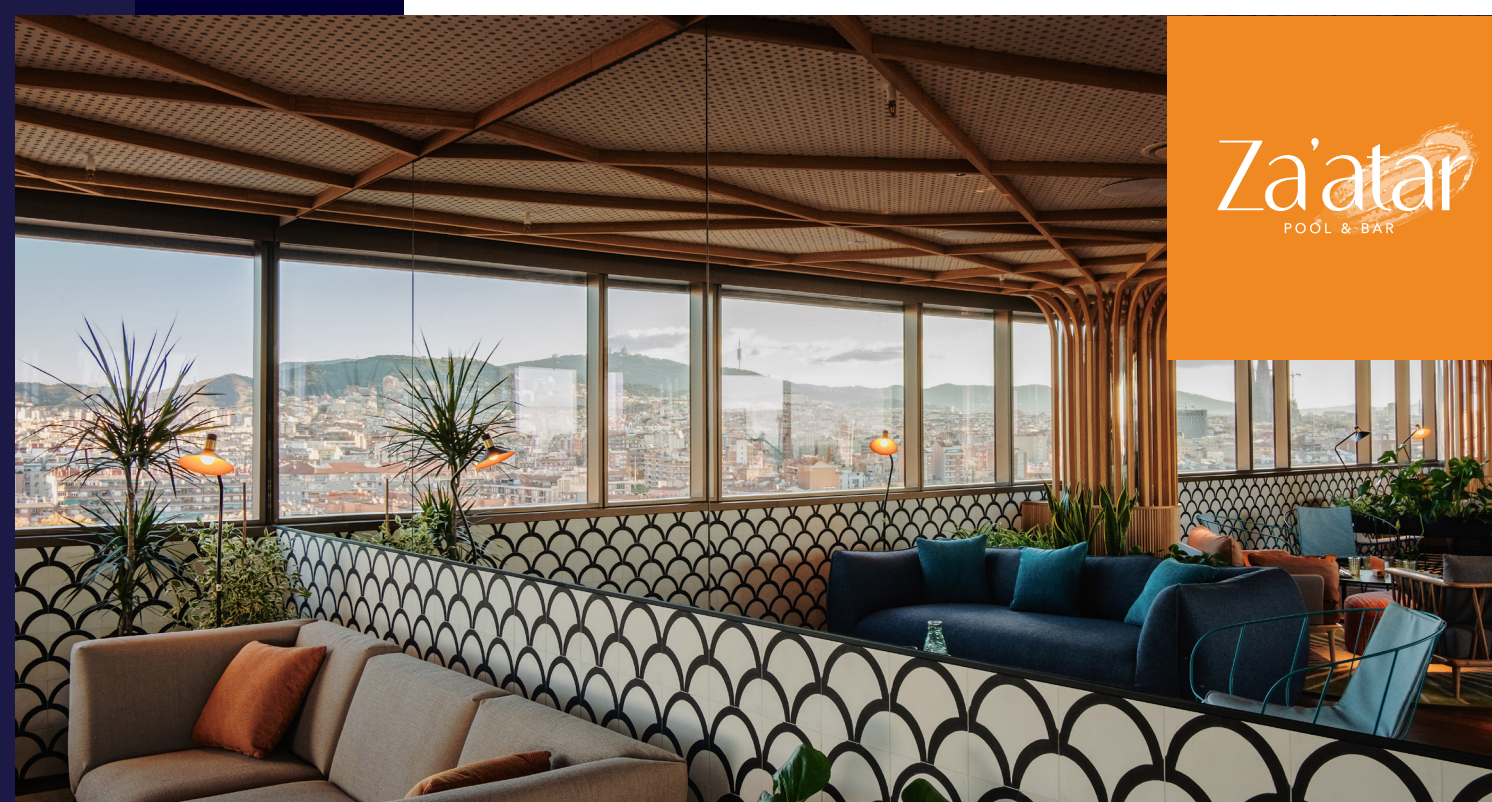

Za'atar. The ultimate destination for culinary adventurers seeking a one-of-a-kind rooftop drink and bite experience.

[VIEW THE FULL BROCHURE](#)



Bar22 welcomes office goers and hotel guests, offering morning coffee and juice takeaways and transforming into a lively destination for cocktails and drinks throughout the day and evening.

DINING EXPERIENCES



International Cuisine - seafood minded all-day restaurant where we serve 50% fish, 30% veggies & vegan dishes and a very small amount of meat, only 20% of our menu will have the best quality meat on it.

Always fresh, easy, light, local, and rich of flavours. Seafood minded with an international cuisine.

Important key elements for our concept is sustainability, quality and for everyone easily accessible.

The culinary offerings of Za'atar Pool & Bar is a fusion of Middle Eastern & Mediterranean traditions, delivering an authentic and flavorful experience. Each dish is meticulously crafted with love and expertise, celebrating the diverse and rich flavors of the regions. Za'atar takes you on a culinary journey, presenting a harmonious blend of cherished classics and contemporary interpretations, tantalizing the taste buds and leaving you craving for more.

Beyond its culinary delights, Za'atar Pool & Bar serves as a welcoming social hub, inviting hotel guests and visitors alike to connect, relish the positive ambiance, and immerse themselves in the inviting vibe. Its 360-degree rooftop ensures a panoramic view, making every moment spent here truly unforgettable.

Za'atar
POOL & BAR



HOTEL EVENTS

This ultra-modern establishment represents a remarkable symbiosis of technology, creativity, and sustainability, boasting a human-focused design supported by cutting-edge technology that ensures both comfort and user-friendly facilities

OPEN TO HOST

Labtwentytwo as a venue provides a sophisticated and versatile setting for a wide range of events. From elegant weddings and corporate conferences to intimate gatherings and grand celebrations, our hotel offers a meticulously curated event space that caters to diverse needs. Our team of dedicated professionals is committed to ensuring every detail is flawlessly executed, from personalized event planning to exquisite catering services. With state-of-the-art facilities, and a commitment to unparalleled service, our hotel is the premier choice for creating unforgettable memories and successful events. Whether you seek a refined corporate affair or a more intimate setting, our hotel is designed to elevate your event to new heights, making it a truly memorable and seamless experience for both hosts and guests alike.

Get in touch with our events team today, and embark on the journey of planning your next unforgettable occasion.

+34 93 714 0718



SUSTAIN ABILITY

Labwtentytwo Barcelona, a Tribute Portfolio Hotel by Marriott, and proudly operated by Odyssey Hotel Group is committed to making a positive and sustainable impact wherever we do business.

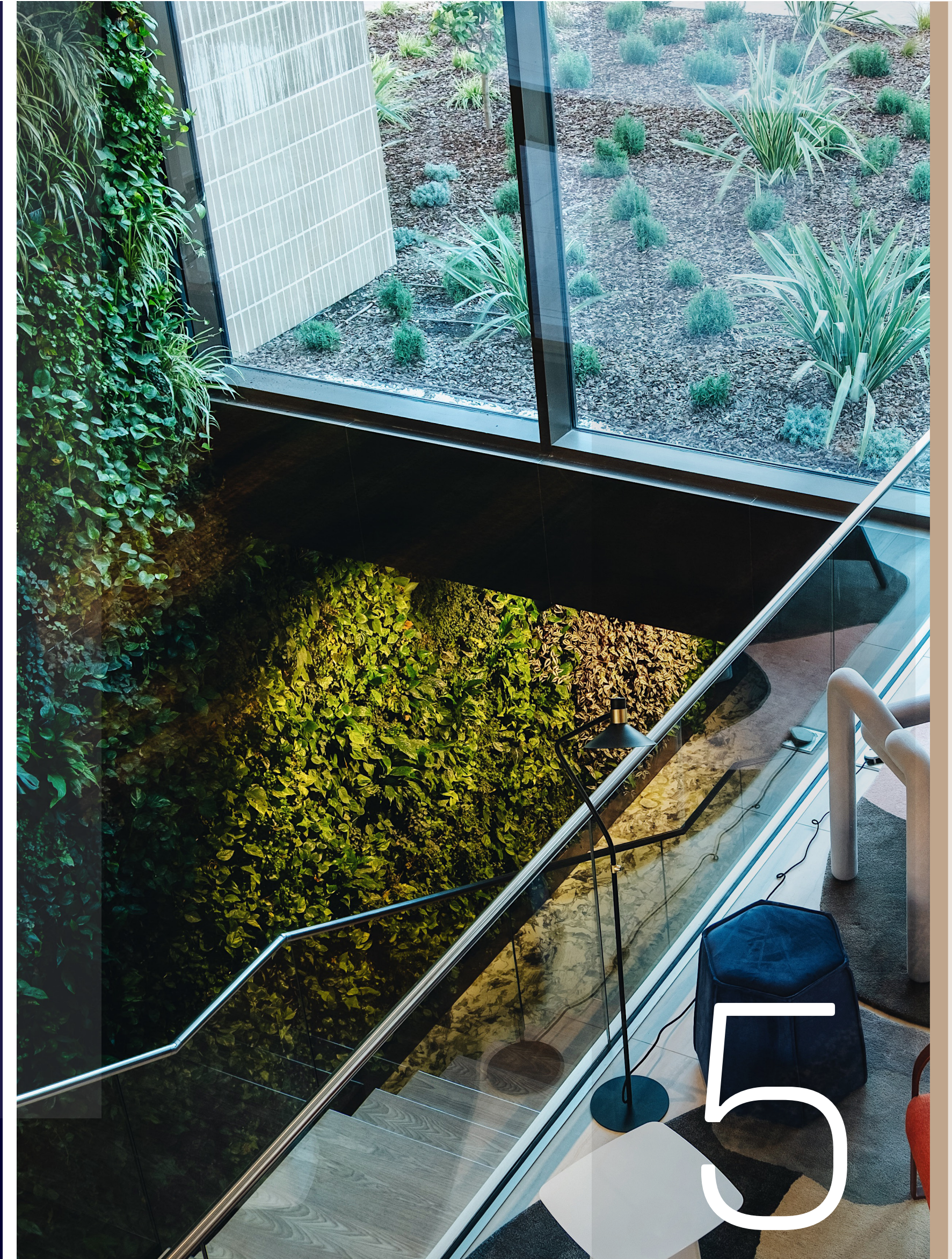

SUSTAINABILITY INITIATIVES

Sustainability lies at the very core of our hotel's foundation. Our dedication to the future entails safeguarding it

Obtaining LEED and WELL certifications for our hotel underscores our unwavering commitment to sustainable, guest-centric excellence, ensuring environmental responsibility, cost-efficiency, guest satisfaction, and the well-being of both our valued guests and dedicated staff.

LEED certification validates our hotel's efficient energy usage, carbon emissions reduction, waste management, and air quality. As guests increasingly seek sustainable resources and evaluate indoor environments for health, our commitment to sustainable construction is evident.



WELL signifies our unwavering commitment to prioritizing people. Every person who enters our establishment can trust that we not only meet but surpass industry standards for health and well-being. After all, everyone deserves to live their healthiest and best life possible.

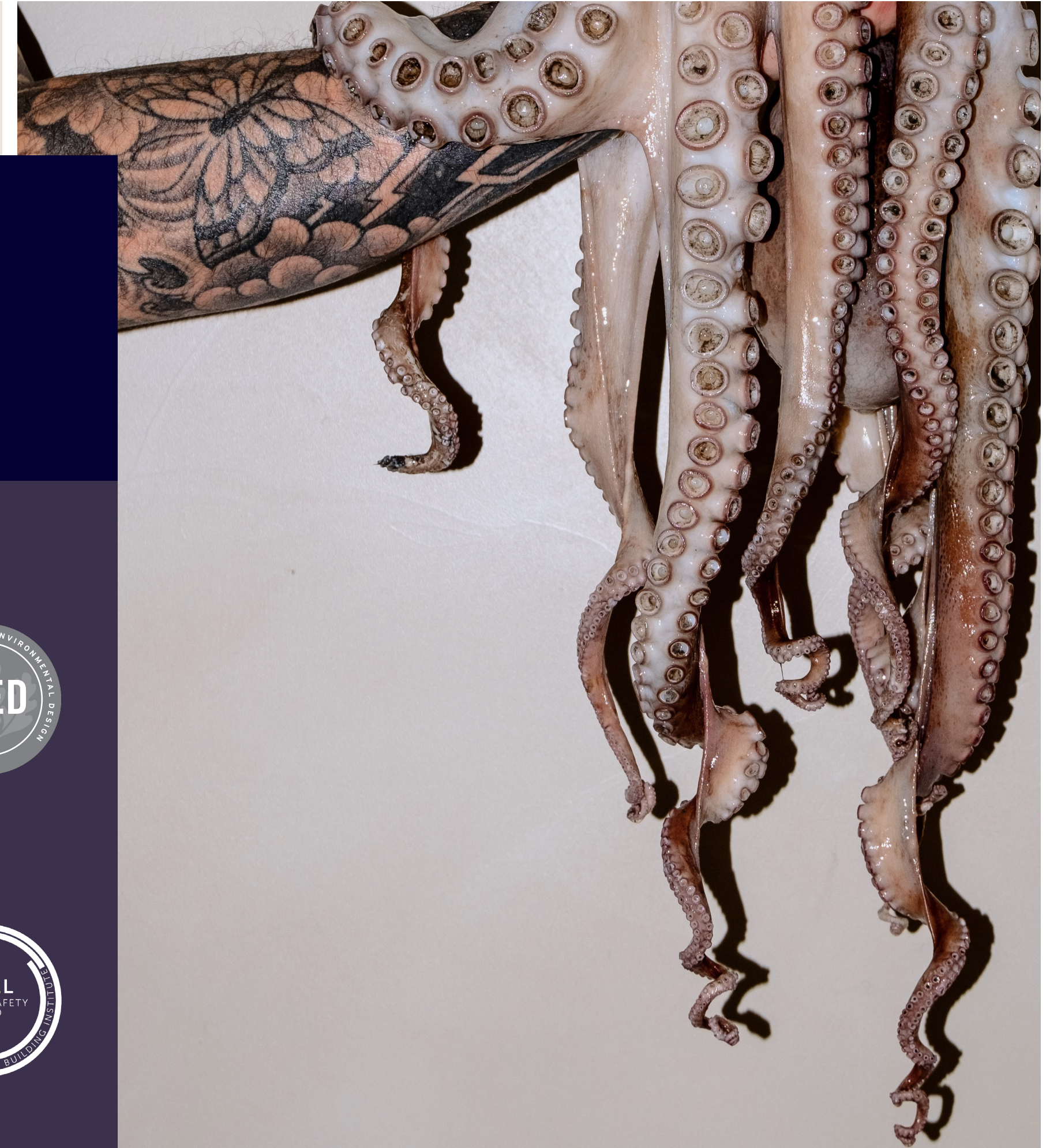

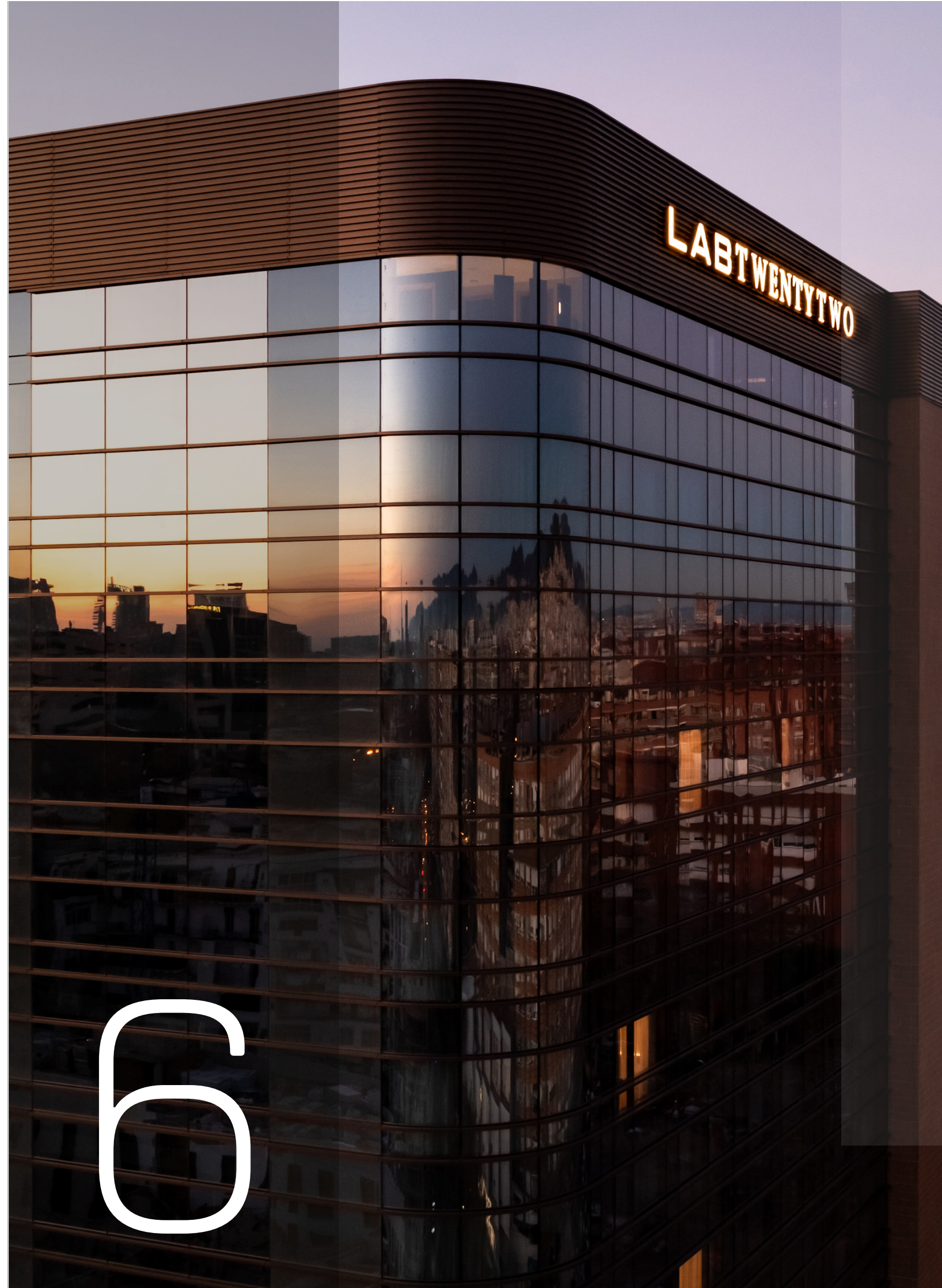

CONTACT & DIRECTIONS

Poble Nou is well-connected by public transportation, including metro and buses, making it easy to travel to other parts of Barcelona.

REACHING THE HOTEL

Airport

The closest airport to Labtwentytwo is El Prat, Barcelona

By Car

The hotel can be reached within 25 minutes

By Public transport

The hotel can be reached within 40 minutes

2 Routes on The Aerobus from either Terminal 1 or 2 take 25 minutes and four stops to reach Plaça Catalunya (the city centre) from where guests can easily navigate to Labtwentytwo using both metro and bus lines.

Metro

2 Metro stops within 15 minutes walk from the hotel:

El Clot-Aragó:

Red Metro Line - 11 minutes walk

Poble Nou:

Yellow Line - 15 minutes walk

Bus

2 bus stops within 9 minutes walk from hotel:
Poble Nou and Plaça de les Glòries Catalanes.

Bus lines: 192, 7, B20, B25



LAB TWENTYTWO
BARCELONA

CARRER DEL PERU 102
BARCELONA, SPAIN, 08018

+34 93 714 0718



Proudly operated by

